

**Main Floor**  
**1470 SQ FT**  
 Ceiling Height 8' 0"



| 7970 RICHARDS TRAIL |          |         |       |            |      |             |       |  |
|---------------------|----------|---------|-------|------------|------|-------------|-------|--|
| FLOOR               | FINISHED | STORAGE | PORCH | PATIO/DECK | SHED | GARAGE/WORK | TOTAL |  |
| LOWER               | 1382     | 263     | 56    | 155        | 0    | 419         | 2275  |  |
| MAIN                | 1470     | 54      | 176   | 604        | 201  | 738         | 3243  |  |
| TOTAL               | 2852     | 317     | 232   | 759        | 201  | 1157        | 5518  |  |

PLANS MAY NOT BE 100% ACCURATE, IF CRITICAL BUYER TO VERIFY.  
 FLOOR PLAN PREPARED FOR EXCLUSIVE USE OF

**Elizabeth Biberger & Associates**



**Lower Floor**  
**1327 SQ FT**  
 Ceiling Height 8' 5"



| 7970 RICHARDS TRAIL  |             |            |            |            |            |             |             |
|--|-------------|------------|------------|------------|------------|-------------|-------------|
| FLOOR  | FINISHED    | STORAGE    | PORCH      | PATIO/DECK | SHED       | BARAGE/WORI | TOTAL       |
| LOWER  | 1382        | 263        | 56         | 155        | 0          | 419         | 2275        |
| MAIN   | 1470        | 54         | 176        | 604        | 201        | 738         | 3243        |
| <b>TOTAL</b>   | <b>2852</b> | <b>317</b> | <b>232</b> | <b>759</b> | <b>201</b> | <b>1157</b> | <b>5518</b> |
| PLANS MAY NOT BE 100% ACCURATE, IF CRITICAL BUYER TO VERIFY. |             |            |            |            |            |             |             |
| FLOOR PLAN PREPARED FOR EXCLUSIVE USE OF                     |             |            |            |            |            |             |             |

**Elizabeth Biberger & Associates**

**Workshop**

**738 SQ FT**

Ceiling Height 9'8"

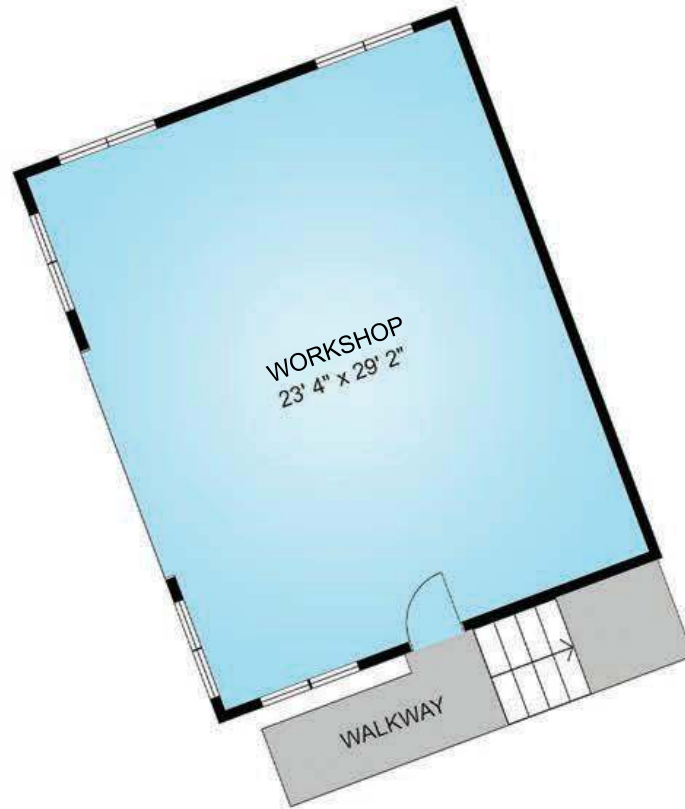

| 7970 RICHARDS TRAIL  |             |            |            |            |            |             |             |
|--|-------------|------------|------------|------------|------------|-------------|-------------|
| FLOOR  | FINISHED    | STORAGE    | PORCH      | PATIO/DECK | SHED       | GARAGE/WORK | TOTAL       |
| LOWER  | 1382        | 263        | 56         | 155        | 0          | 419         | 2275        |
| MAIN   | 1470        | 54         | 176        | 604        | 201        | 738         | 3243        |
| <b>TOTAL</b>   | <b>2852</b> | <b>317</b> | <b>232</b> | <b>759</b> | <b>201</b> | <b>1157</b> | <b>5518</b> |
| PLANS MAY NOT BE 100% ACCURATE, IF CRITICAL BUYER TO VERIFY. |             |            |            |            |            |             |             |
| FLOOR PLAN PREPARED FOR EXCLUSIVE USE OF                     |             |            |            |            |            |             |             |

**Elizabeth Biberger & Associates**



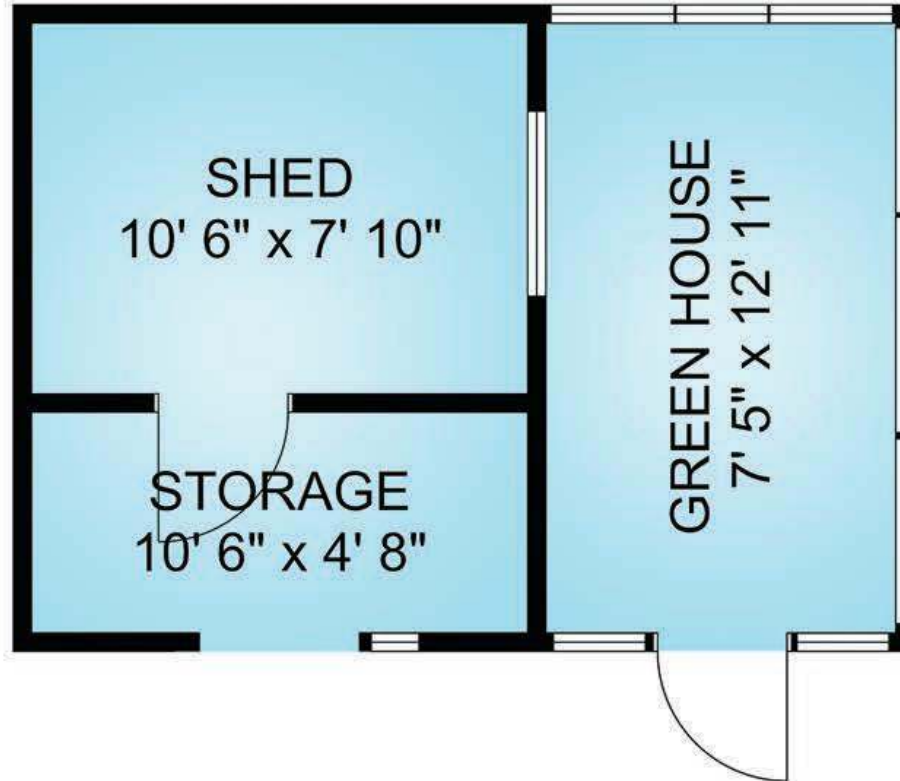

| 7970 RICHARDS TRAIL  |             |            |            |            |            |             |             |
|--|-------------|------------|------------|------------|------------|-------------|-------------|
| FLOOR  | FINISHED    | STORAGE    | PORCH      | PATIO/DECK | SHED       | BARAGE/WORK | TOTAL       |
| LOWER  | 1382        | 263        | 56         | 155        | 0          | 419         | 2275        |
| MAIN   | 1470        | 54         | 176        | 604        | 201        | 738         | 3243        |
| <b>TOTAL</b>   | <b>2852</b> | <b>317</b> | <b>232</b> | <b>759</b> | <b>201</b> | <b>1157</b> | <b>5518</b> |
| PLANS MAY NOT BE 100% ACCURATE, IF CRITICAL BUYER TO VERIFY. |             |            |            |            |            |             |             |
| FLOOR PLAN PREPARED FOR EXCLUSIVE USE OF                     |             |            |            |            |            |             |             |

Elizabeth Biberger & Associates

